

Auszug aus unserem Lieferprogramm

Unterschranke

Korpshöhe: 76,8cm

Schrantiefe: 58,2cm

U 20 U 45 U 60
U 30 U 50
U 40 U 55

U 80
U 90
U 100

UTR 20
UTR 30

UD 25

UDZ 15
UDZ 25

US 30 US 50
US 40 US 55
US 45 US 60

U2Z 30 U2Z 50
U2Z 40 U2Z 55
U2Z 45 U2Z 60

U2Z 80 U2Z 100
U2Z 90 U2Z 120

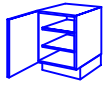

*1

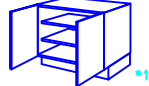

*1

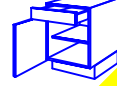

*1,2

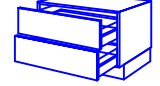
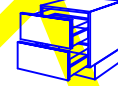

USZ 30 USZ 50
USZ 40 USZ 55
USZ 45 USZ 60

USZ 80 USZ 100
USZ 90 USZ 120

U3A 30 U3A 50
U3A 40 U3A 55
U3A 45 U3A 60

U3A 80 U3A 100
U3A 90 (U3A 120)

USA 30 USA 50
USA 40 USA 55
USA 45 USA 60

USA 80 USA 100
USA 90 USA 120

U2ZR 40 U2ZR 55
U2ZR 45 U2ZR 60

U2ZR 80 U2ZR 100
U2ZR 90



*1,2



*2

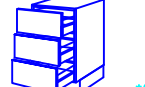

*2



*2



*2

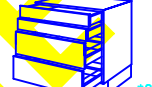

*2



USZR 40 USZR 55
USZR 45 USZR 60
USZR 50

USZR 80 USZR 100
USZR 90

U3SZ 30 U3SZ 50
U3SZ 40 U3SZ 55
U3SZ 45 U3SZ 60

U3SZ 80 U3SZ 100
U3SZ 90 U3SZ 120

U4SA 30 U4SA 50
U4SA 40 U4SA 55
U4SA 45 U4SA 60

U4SA 80 U4SA 100
U4SA 90 U4SA 120

U6S 30 U6S 50
U6S 40 U6S 55
U6S 45 U6S 60

U6S 80 U6S 100
U6S 90



*2



*2



*1,2

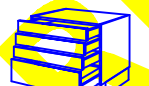

Eck-Unterschranke

UFSZ 30
UFSZ 40

UHK 105

USK 105

UAK 110

UASK 110

ULK 115
ULK110

UK 80
UK 90

UKD 90

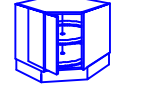
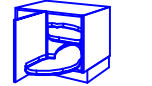
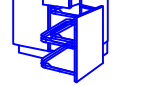
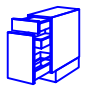

Spülen-Unterschranke

UP 40 UP 55
UP 45 UP 60
UP 50

UPAZ 2 45
UPAZ 2 50
UPAZ 2 60
UPAZ 3 60

UP2Z 45 UP2Z 60
UP2Z 50
UP2Z 55

UP2Z 80
UP2Z 90
UP2Z 100

UPE 105 UPE 125
UPE 110
UPE 115

UPD 90

Abfallsammler-Unterschranke

UASZ 2 30

UA2Z

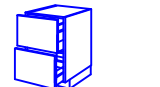
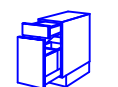
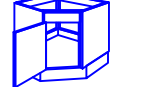
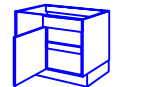
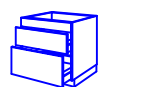
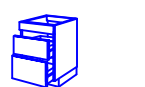
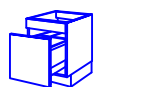
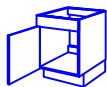

Geräte-Unterschranke

UHUO 60
UHUO 70

UHU 60
UHU 70

UHUS 60

UCSZ 60 UCSZ 100
UCSZ 80 UCSZ 120
UCSZ 90

UCSA 60 UCSA 100
UCSA 80 UCSA 120
UCSA 90

Unterschrank-Regale

URO 20 URO 55
URO 30 URO 60
URO 40 URO 80
URO 45 URO 90
URO 50 URO 100

UDO 25

URFL 15

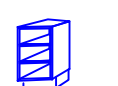
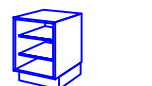
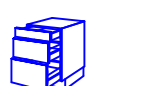

*1 auch 35,2 tief
*2 auch 68,2 tief

alle Schrankhöhen- Angaben zuzüglich Sockel + Arbeitsplatte